

# Urban Architecture Lighting



# Urban Architecture Lighting

## Techno Commerical Data Sheet

PRODUCT CODE	CATALOGUE REFERENCE	LAMP TYPE	LAMP BASE	LIST PRICE
110202	BNOB 218 O	'D' type CFL 2 x 18W	G24d-2	6975.00
110203	BNOB 226 O	'D' type CFL 2 x 26W	G24d-2	6975.00
110300+160270	BNCL 70 SV C WOB + BJOS 70 SV/MH	HPSV T 70W	E 27	11850.00
110296+160270	BNCL 70 MH C WOB + BJOS 70 SV/MH	MH T 70W	E 27	11900.00
110301+160270	BNCL 70 SV O WOB + BJOS 70 SV/MH	HPSV T 70W	E 27	10130.00
110297+160270	BNCL 70 MH O WOB + BJOS 70 SV/MH	MH T 70W	E 27	10180.00
110303+162109	BNCL 150 SV C WOB+ BJOS 150 SV/MH	HPSV T 70W	E 27	12350.00
110302+162109	BNCL 150 MH C WOB + BJOS 150 SV/MH	MH T 150W	E 27	12400.00
110305+162109	BNCL 150 SV O WOB+ BJOS 150 SV/MH	HPSV T 150W	E 27	10640.00
110304+162109	BNCL 150 MH O WOB+ BJOS 150 SV/MH	MH T 150W	E 27	10690.00
110329+160270	BNCS 70 SV C WOB + BJOS 70 SV/MH	HPSV T 150W	E 27	10350.00
110330+160270	BNCS 70 MH C WOB + BJOS 70 SV/MH	MH T 70W	E 27	10400.00
110331+160270	BNCS 70 SV O WOB + BJOS 70 SV/MH	HPSV T 70W	E 27	8700.00
110332+160270	BNCS 70 MH O WOB + BJOS 70 SV/MH	MH T 70W	E 27	8750.00
110333+162109	BNCS 150 SV C WOB + BJOS 150 SV/MH	HPSV T 150W	E 27	10850.00
110334+162109	BNCS 150 MH C WOB + BJOS 150 SV/MH	MH T 150W	E 27	10900.00
110335+162109	BNCS 150 SV O WOB + BJOS 150 SV/MH	HPSV T 150W	E 27	9200.00
110336+162109	BNCS 150 MH O WOB + BJOS 150 SV/MH	MH T 150W	E 27	9250.00
110327+160270	BNST 70 SV O WOB + BJOS 70 SV/MH	HPSV T 70W	E 27	7850.00
110328+160270	BNST 70 MH O WOB + BJOS 70 SV/MH	MH T 70W	E 27	7900.00
162560	BRIL 01 70 MH DE	MH DE 70W	Rx 7s	19000.00
162561	BRIL 01 150MH DE	MH DE 150W	Rx 7s-24	19500.00
162562	BRIL 22 70MH DE	MH DE 70W	Rx 7s	11650.00
162563	BRIL 22 150 MH DE	MH DE 150W	Rx 7s-24	12300.00
524364	BJCPTI 111 Opal	'S' type CFL 1 x 11W	G23	1975.00
524363	BJCPTI 111 Clear	'S' type CFL 1 x 11W	G23	2480.00
160368	BJCPTI 118 Opal	'D' type CFL 1 x 18W	G24d-2	2010.00
160339	BJCPTI 118 Clear	'D' type CFL 1 x 18W	G24d-2	2520.00
524366	BJCPTI 211 Opal	'S' type CFL 2 x 11W	G23	3215.00
524365	BJCPTI 211 Clear	'S' type CFL 2 x 11W	G23	4200.00
160559	BJCPTI 218 Opal	'D' type CFL 2 x 18W	G24d-2	3280.00
160408	BJCPTI 218 Clear	'D' type CFL 2 x 18W	G24d-2	4265.00
160614	BJGLI 211 Clear	'S' type CFL 2 x 11W	G23	5040.00
160430	BRPTI 111 Opal	'S' type CFL 1 x 11W	G23	1650.00
160431	BRPTI 111 Clear	'S' type CFL 1 x 11W	G23	2335.00
160432	BRPTI 118 Opal	'D' type CFL 1 x 18W	G24d-2	1760.00
160433	BRPTI 118 Clear	'D' type CFL 1 x 18W	G24d-2	2445.00
160434	BRPTCI 111 Opal	'S' type CFL 1 x 11W	G23	2000.00
160435	BRPTCI 111 Clear	'S' type CFL 1 x 11W	G23	2635.00
160436	BRPTCI 118 Opal	'D' type CFL 1 x 18W	G24d-2	2120.00
160437	BRPTCI 118 Clear	'D' type CFL 1 x 18W	G24d-2	2755.00
524810	Spigot for BJMPTI/DPTI/SPTI/TPTI 80 MV LPF#	HPMV 80W	E 27	1900.00
524821	Spigot for BJMPTI/DPTI/SPTI/TPTI 125 MV LPF	HPMV 125W	E 27	1925.00
524830	Spigot for BJMPTI/DPTI/SPTI/TPTI 70 SV LPF	HPSV 70W	E 27	2150.00
024800	Mushroom shape Roto Mould Diffuser*			1575.00
024900	Diamond shape Roto Mould Diffuser**			1490.00
024890	Spherical shape Roto Mould Diffuser***			1490.00
520035	Temple shape Roto Mould Diffuser****			1670.00

Note: For Mushroom shape post top lantern please order (#)+(\*); For Diamond shape post top lantern please order (#)+(\*\*); For Spherical shape post top lantern please order (#)+(\*\*\*) ; For Temple shape post top lantern please order (#)+(\*\*\*\*);



PRODUCT CODE	CATALOGUE REFERENCE	LAMP TYPE	LAMP BASE	LIST PRICE
024320	BJPTL (Use seperate CG for HID lamp)		E 27	1950.00
162441 + 161818	BJPTI 80 MV WOB + BJOR 80 MV	HPMV 80W	E 27	3550.00
162442 + 161849	BJPTI 125 MV WOB + BJOR 125 MV	HPMV 125W	E 27	3700.00
162443 + 160270	BJPTI 70 SV WOB + BJOR 70 SV/MH	HPSV 70W	E 27	3900.00
162493	BJODC 1170 SV/MH	MH/SV T 70W	E 27	3230.00
162494	BJODC 1170 MH DE	MH DE T 70W	Rx 7s	3360.00
162505	BJODC 150 SV/MH	MH/SV T 150W	E 27	5590.00
162506	BJODC 150 MH DE	MH DE 150W	E 27	5720.00
162519	BJDOC 250/400 SV/MH	MH/SV T 250/400W	E 40	7600.00
162496	BJODC 3 X 1170 SV/MH*	3 X MH/SV T 70W	E 27	39700.00
162497	BJODC 3 X 1170 MH DE*	3 X MH DE T 70W	Rx 7s	39700.00
162507	BJODC 3 X 150 SV/MH*	3 X MH/SV T 150W	E 27	25870.00
162508	BJODC 3 X 150 M H DE*	3 X MH DE 150W	Rx 7s-24	26260.00
162521	BJDOC 3 X 250/400 SV/MH*	3 X MH/SV T 250/400W	E 40	39600.00
162159+160270	BJODCI 1170 SV WOB + BJOS 70 SV/MH	HPSV T 70W	E 27	4000.00
162160+160270	BJODCI 1170 MH WOB + BJOS 70 SV/MH	MH T 70W	E 27	4050.00
162161+160270	BJODCI 1170 MH DE WOB + BJOS 70 SV/MH	MH DE 70W	Rx 7s	4330.00
162509+192109	BJODCI 150 SV WOB + BJOS 150 SV/MH	HPSV T 150W	E 40	6790.00
162512+162109	BJODCI 150 MH (E40) WOB + BJOS 150 SV/MH	MH T 150W	E 40	6840.00
162522+160272	BJODCI 250 SV WOB + BJOS 250 SV/MH	HPSV T 250W	E 40	9175.00
162523+160272	BJODCI 250 MH WOB + BJOS 250 SV/MH	MH T 250W	E 40	9225.00
162428+028213	BJODCI 400 SV WOB + BJS 400 SV/MH	HPSV T 400W	E 40	10200.00
162429+028213	BJODCI 400 MH WOB + BJS 400 SV/MH	MH T 400W	E 40	10250.00
162502+160270	BJODCI 3 x 1170 SV WOB + 3 x BJOS 70 SV/MH	3 x HPSV T 70W	E 27	21100.00
162503+160270	BJODCI 3 x 1170 MH WOB + 3 x BJOS 70 SV/MH	3 x MH T 70W	E 27	22090.00
162504+160270	BJODCI 3 x 1170 MH DE WOB + 3 x BJOS 70 SV/MH	3 x MH DE 70W	Rx 7s	22090.00
162513+160109	BJODCI 3 x 150 SV WOB + 3 x BJOS 150 SV/MH	3 x HPSV T 150W	E 40	29470.00
162514+162109	BJODCI 3 x 150 MH (E40) WOB + 3 x BJOS 150 SV/MH	3 x HPSV T 250W	E 40	29620.00
162524+160272	BJODCI 3 X 250 SV WOB + 3 x BJOS 250 SV/MH	3 X HPSV 250W	E 40	44325.00
162525+160272	BJODCI 3 X 250 MH WOB + 3 x BJOS 250 SV/MH	3 X MH T 250W	E 40	44475.00
162526+028213	BJODCI 3 X 400 SV WOB + 3 x BJS 400 SV/MH	3 X HPSV 400W	E 40	47400.00
162527+028213	BJODCI 3 X 400 MH WOB + 3 x BJS 400 SV/MH	3 X MH T 400W	E 40	47550.00
916229	Centre Pole mounting Pipe assembly		-	9100.00
916230	Centre Pole mounting Pipe assembly		-	16800.00
162416 + 160270	BRSGL 70 SV WOB (12") + BJOS 70 SV/MH	HPSV T 70W	E 27	On Request
	BRSGL 70 MH WOB (12") + BJOS 70 SV/MH	MH SE 70W	E 27	On Request
161311+162109	BRSGL 150SV WOB (19") + BJOS 150 SV/MH	HPSV T 150W	E 27	9625.00
161808+162109	BRSGL 150MH WOB (19") + BJOS 150 SV/MH	MH SE 150W	E 27	9675.00
161809+160272	BRSGL 250SV WOB (19") + BJOS 250 SV/MH	HPSV T 250W	E 27	10850.00
161812+160272	BRSGL 250MH WOB (19") + BJOS 250 SV/MH	MH T 250W	E 27	10900.00
161813+028213	BRSGL 400SV WOB (19") + BJS 400 SV/MH	HPSV T 400W	E 40	14200.00
161814+028213	BRSGL 400MH WOB (19") + BJS 400 SV/MH	MH T 400W	E 40	14250.00
162032 + 162109	BRSGL 150SV TM WOB + BJOS 150 SV/MH	HPSV T 150W	E 27	9625.00
161722 + 162109	BRSGL 150MH TM WOB + BJOS 150 SV/MH	MH SE 150W	E 27	9675.00
162331 + 160272	BRSGL 250SV TM WOB + BJOS 250 SV/MH	HPSV T 250W	E 27	10850.00
	BRSGL 250MH TM WOB + BJOS 250 SV/MH	MH T 250W	E 27	10900.00
	BRSGL 400SV TM WOB + BJS 400 SV/MH	HPSV T 400W	E 40	14200.00
	BRSGL 400MH TM WOB + BJS 400 SV/MH	MH T 400W	E 40	14250.00
110144	BECBL 01 118 CFL	'D' type CFL 1 x 18W	G24d-2	17000.00
110145	BECBL 02 126 CFL	'D' type CFL 1 x 26W	G24d-2	17100.00
110146	BECBL 02 126 CFL	'D' type CFL 1 x 26W	G24d-2	14100.00
110147	BECBL 02 118 CFL	'D' type CFL 1 x 18W	G24d-2	14000.00



# Urban Architecture Lighting

## Techno Commerical Data Sheet

PRODUCT CODE	CATALOGUE REFERENCE	LAMP TYPE	LAMP BASE	LIST PRICE
160438	BRBOL 111	'S' type CFL 1 x 11W	G23	5525.00
160439	BRBOL 118	'D' type CFL 1 x 18W	G 24d-2	5625.00
160442	BRBODC 111	'S' type CFL 1 x 11W	G23	7525.00
160443	BRBODC 118	'D' type CFL 1 x 18W	G 24d-2	7625.00
160101	BJBOL 02 29 CFL	'S' type CFL 2 x 9W	G23	4400.00
160124	BJBOL 02 213 CFL	'D' type CFL 1 x 13W	G 24d-2	4660.00
160125	BJBOL 02 218 CFL	'D' type CFL 2 x 18W	G 24d-2	4720.00
160126	BJBOL 03 29 CFL	'S' type CFL 2 x 9W	G23	5140.00
160127	BJBOL 03 213 CFL	'D' type CFL 2 x 13W	G 24d-2	5390.00
160128	BJBOL 03 218 CFL	'D' type CFL 2 x 18W	G 24d-2	5450.00
161268	BLWUD 23 PAR	PAR 1 X 50W	E 27	On Request
	BLUDL 70 CDMT	CDMT 1 x 70W	G 12	On Request
110138	BEGPL 113 CFL	'D' type CFL 1 X 13W	G24d-2	2000.00
110139	BEGPL 118 CFL	'D' type CFL 1 X 18W	G24d-2	2050.00
110141	BEOPL 113 CFL	'D' type CFL 1 X 13W	G24d-2	1800.00
110142	BEOPL 118 CFL	'D' type CFL 1 X 18W	G24d-2	1850.00
110052	BETBL 50 DH	DH 1 X 50W	GU 10	2300.00
110054	BEBL 50 DH	DH 1 X 50W	GU 10	2100.00
110053	BEGBL 50 DH	DH 1 X 50W	GU 10	2300.00
110055	BEPBL 50 DH	DH 1 X 50W	GU 10	2300.00
110171	BEWOL 50 DH SS	DH 1 X 50W	GU 10	3600.00
110148	BEWOL 70 MH DE AL AS	MH DE 1 X 70W	Rx 7s	8650.00
110149	BEWOL 70 MH DE AL S	MH DE 1 X 70W	Rx 7s	8650.00
110151	BEWOL 70 MH DE SS AS	MH DE 1 X 70W	Rx 7s	13000.00
110152	BEWOL 70 MH DE SS S	MH DE 1 X 70W	Rx 7s	13000.00
161871	BRWOL 70 MH DE SQ	MH DE 1 X 70W	Rx 7s	7250.00
230197	BRWOL 150 MH DE SQ	MH DE 1 X 150W	Rx 7s-24	7750.00
230192	BRWOL 150 MH SE	MH E27 1 X 150W	Rx 7s-24	On Request
161896	BEUWL 150 DH 12V without transformer* (* Use seperate transformer will be supplied extra cost.)	DH 1 X 50W 12V	GU 5,4	7500.00
110049	BESBL 150DH	PAR 1 X 50W	E 27	2400.00
110050	BESGBL 150 DH	PAR 1 X 50W	E 27	2400.00
110091	BEBHL 150 PAR16	PAR 1 X 50W	E 27	1900.00
110190	BEFL 70 MH DE without accessories	MH DE 1 X 70W	Rx 7s	4000.00
110166	Accessories - Ballast, Ignitor, Capacitor & Tray	-	-	1850.00
110190	BEFL 150 MH DE without accessories	MH DE 1 X 150W	Rx 7s-24	4000.00
911002	Accessories - Ballast, Ignitor, Capacitor & Tray	-	-	2250.00
110154	BEBCL 06 045 LED White*	Built in White LED	-	5000.00
110155	BEBCL 06 045 LED RED*	Built in RED LED	-	5000.00
110156	BEBCL 06 045 LED GREEN*	Built in Green LED	-	5000.00
110157	BEBCL 06 045 LED BLUE*	Built in Blue LED	-	5000.00
110158	BEBCL 18 103 LED RGB	-	-	6000.00
110159	BEBCLTR 24W 24V DC# For walkover LED brick luminaires order (#)+(*)	-	-	4000.00
	BRPRL 70 SV/MH	HPSV/MH T 70W	-	On Request
	BRPRL 150 SV/MH	HPSV/MH T 150W	-	On Request
	BJPL 01	-	-	On Request
	BJPL 02	-	-	On Request
	BJPL 03	-	-	On Request
	BEIP3M SA 70 MH DE 218/226 RF	MH DE 70W	-	On Request
	BEIP3M SA 150 MH DE 218/226 RF	MH DE 150W	-	On Request



## Branch Address:-

### AHMEDABAD

106, Sakar III, Off Ashram Road  
 Navrangpura, Ahmedabad 380 014.  
 Phone: 27543964, 27543967, 27540397  
 Fax: 079-27543950  
 Email: ahm\_cic@bajajelectricals.com

### BANGALORE

Bajaj Bhavan, No. 16, Residency Road,  
 Bangalore 560 025.  
 Phone: 22235486, 22238984, 22275505  
 Fax: 080-22214878-22275505  
 Email: ban\_cic@bajajelectricals.com

### BHUBANESWAR

Kharavela Nagar, Janpath,  
 Bhubaneswar 751 001.  
 Phone: 2390697, 2396980, 2394052  
 Fax: 0674-2390294  
 Email: bhu\_cic@bajajelectricals.com

### CHANDIGARH

SCO 52, Sector-26, Madhya Marg,  
 Chandigarh 160 026.  
 Phone: 5005778, 5005779  
 Fax: 0172-2792932  
 Email: chd\_cic@bajajelectricals.com

### CHENNAI

195, Anna Salai, Chennai 600 002.  
 Phone: 42162200, Fax: 044-42163300  
 Email: che\_cic@bajajelectricals.com

### COCHIN

CRL House, 42/1107, Tata Oil Mills Road,  
 Cochin 682 018.  
 Phone: 2391119, 2396128, 2392039  
 Fax: 0484-2391744  
 Email: ccn\_cic@bajajelectricals.com

### DELHI

1/10, Asaf Ali Road, New Delhi 110 002  
 Phone: 23236055, 23233056, 23235057  
 Fax: 011-23230214  
 Email: del\_cic@bajajelectricals.com

### GUWAHATI

Agarwal House, Christian Basti,  
 G.S. Road, Guwahati 787 005.  
 Phone: 2346497, 2346498, 2346499  
 Fax: 0361-2346496  
 Email: guw\_cic@bajajelectricals.com

### HYDERABAD

H. No. 6-3-1090/2, 3rd Floor,  
 Vithal Das Chambers,  
 Rajbhavan Road, Somaji Guda,  
 Hyderabad 500 082.  
 Phone: 23442932, 23442933, 23442934  
 Fax: 040-23302745  
 Email: hyd\_cic@bajajelectricals.com

### INDORE

Commerce House, 3 rd Floor,  
 7 Race Course Road,  
 Indore 452 003, MP.  
 Phone: 2548909-10-18  
 Fax: 0731-2548911  
 Email; ind\_cic@bajajelectricals.com

### JAIPUR

Raghukamal Niwas, M. I. Road,  
 Jaipur 302 001.  
 Phone: 2377364, 2369541, 2369542  
 Fax: 0141-2374261  
 Email: jai\_cic@bajajelectricals.com

### KOLKATA

10, Ganesh Chandra Avenue,  
 Kolkata 700 013.  
 Phone: 22379270, 22377657, 22216638  
 Fax: 033-22259111  
 Email: cal\_cic@bajajelectricals.com

### LUCKNOW

Bajaj Bhavan, 21/32 A, Tilak Marg,  
 Lucknow 226 001.  
 Phone: 2620595/2613549  
 Fax: 0522-2626513  
 Email: luc\_cic@bajajelectricals.com

### MUMBAI

Harchandrai House, 3rd Floor, 81,  
 Queens Road, Marine Lines,  
 Mumbai 400 002.  
 Phone: 22089092, 22089093  
 Fax: 22089193  
 Email: mum\_cic@bajajelectricals.com

### NAGPUR

2nd Floor, Saraf Court, Opp.  
 Yashwant Stadium,  
 Dhantoli, Nagpur.  
 Phone: 2440318, 2440319  
 Fax: 0712-2420102  
 Email: war\_cic@bajajelectricals.com

### NOIDA

Flat No. 505-507, 5th Floor,  
 Vikrant Tower,  
 4, Rajendra Place, Pusa Road,  
 New Delhi 110 008.  
 Phone: 25711961, 25861963, 25861964  
 Fax: 011-25861962  
 Email: dl2\_cic@bajajelectricals.com

### PATNA

Kashi Place, Dak Bunglow Road,  
 Patna 800 001.  
 Phone: 2231427, 2220155, 2225911  
 Fax: 0612-2231978 / 2231427  
 Email: pat\_cic@bajajelectricals.com

### PUNE

Maneck Hall, 2, General Thimmayya Road,  
 Pune 411 001.  
 Phone: 26360801, 26361321, 26360703  
 Fax: 020-26360698  
 Email: pun\_cic@bajajelectricals.com

### RAIPUR

Bajaj Bhavan, Doongaji Colony,  
 G. E. Road, 2660166  
 Near Anupam Udyan, Raipur 492 001.  
 Phone: 2263986, 2263976, 4060166  
 Fax: 0771-2263310  
 Email: rai\_cic@bajajelectricals.com

### LUMINAIRES HEAD OFFICE and R&D OFFICE

15/17, Sant Savta marg, Reay Road,  
 Mumbai 400 010.  
 Phone: 2372 4192  
 Fax: 022-2373 0504

### HEAD OFFICE

51, Mahatma Gandhi Road,  
 Mumbai 400 001.  
 Phone: 22043780, 22851462, 22875135  
 Fax: 022-22828250

### REGISTERED OFFICE

45/47, Veer Nariman Road,  
 Mumbai 400 001.  
 Phone: 22043841, 22045046, 22045341  
 Fax: 022-22851279

- Due to continuous efforts in developing products, improvement - Bajaj Electricals Limited reserves the right to make changes in the design and data without any prior notice.
- The prices are subject to alternation without any prior notice.
- All dimensions are in mm. Tolerance +\_3mm



# Urban Architecture Lighting



**BNOB 218/226 O**

**"NEO" Series - ORBIT** 

**Applications**

Resorts & Townships, Pathways, City Centres, Gardens and Precincts.

**Specification**

Integral post top lantern comprises of white opal acrylic diffuser canopy & opal bowl providing upward and downward light.

"Y" shape pipe arrangement for vertical mounting.

G24d-2 for 18/26w CFL lamp holder, open construction ballast are wired up to the terminal block.

Suitable for 60mm OD pipe entry with fixing bolts.

Ingress protection : IP 54

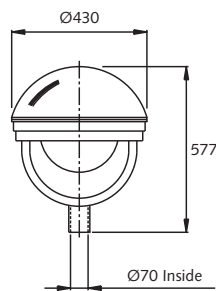

**BNOB 218/226 O**



**BNCL 70 SV/MH C/O**  
**BNCL 150 SV/MH C/O**

**"NEO" Series - CELESTA** 

**Applications**

Resorts & Townships, Pathways, City Centres, Gardens and Precincts.

**Specification**

Integral post top lantern comprises of Copper dust finished die-cast aluminium alloy pole mounting spigot, aluminium canopy housing with all the accessories.

Polycarbonate cover in opal and clear versions.

Aluminium baffles are provided around the lamp to eliminate glare in clear version.

E27 lamp holder for 70W SV/MH LAMP, E40 lamp holder for 150W SV/MH lamp open construction ballast and accessories are wired up to the terminal block.

Suitable for 60mm OD pipe entry with fixing bolts.

Ingress protection : IP 55

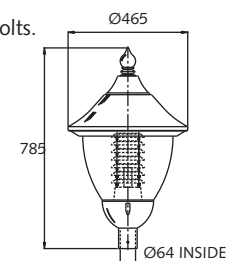

**BNCL 70/150 SV/MH C/O**

Note: "CELESTA" opal version is available with 85W CFL retrofit lamp on request.





**BNCs 70 SV/MH C/O**  
**BNCs 150 SV/MH C/O**

“NEO” Series - COSMOS



**Applications**

Resorts & Townships, Pathways, City Centres, Gardens and Precincts.

**Specification**

Integral post top lantern comprises of Copper dust finished die-cast aluminium alloy pole mounting spigot, aluminium canopy housing with all the accessories.

Polycarbonate cover in opal & clear versions.

Aluminium baffles are provided around the lamp to eliminate glare in clear version.

E27 lamp holder for 70W SV/MH LAMP, E40 lamp holder for 150W SV/MH lamp open construction ballast and accessories are wired up to the terminal block.

Suitable for 60mm OD pipe entry with fixing bolts.

Ingress protection : IP 55

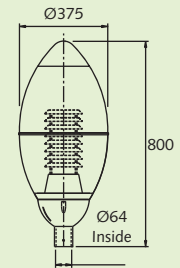

Note: “COSMOS” opal version is available with 85W CFL retrofit lamp on request.

**BNCs 70/150 SV/MH C/O**



# Urban Architecture Lighting



**BNST 70 SV/MH**

“NEO” Series - SHUTTLE



#### Applications

Resorts & Townships, Pathways, City Centres, Gardens and Precincts.

#### Specification

Integral post top lantern comprises of copper dust finished die-cast aluminium alloy pole mounting spigot, aluminium canopy housing with all the accessories.

Opal polycarbonate cover.

E27 lamp holder for 70W SV/MH lamp, open construction ballast and accessories are wired upto the terminal block.

Suitable for 60mm OD pipe entry with fixing bolts.

Ingress protection : IP 55

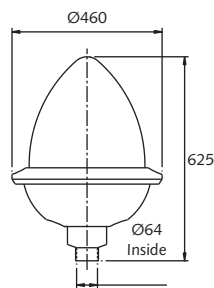

**BNST 70 SV/MH**

Note: “SHUTTLE” opal version is available with 85W CFL retrofit lamp on request.



**BRIL 01 70 MH DE**  
**BRIL 01 150 MH DE**

Renaissance - Indirect

#### Applications

Resorts & Townships, Pathways, City Centres, Gardens and Precincts.

#### Specification

Indirect light integral post top lantern comprises of white painted cast aluminium spigot, lamp housing with toughened glass.

White painted aluminium sheet reflector fixed on tripod directing the light downwards.

Pair of RX 7s 70W MH DE lamp/pair of RX 7s-24 150W MH DE lamp holder, open construction ballast and accessories are wired up to the terminal block.

Suitable upto 70 mm OD pipe entry with fixing bolts.

Ingress protection : IP 54

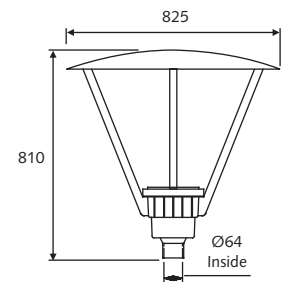

**BRIL 01 70/150 MH DE**





**BRIL 22 70 MH DE**  
**BRIL 22 150 MH DE**

**Renaissance - Indirect**

**Applications**

Resorts & Townships, Pathways, City Centres, Gardens and Precincts.

**Specification**

Indirect light integral post top lantern comprises of white painted cast aluminium spigot lamp housing.

White painted spun aluminium reflector fixed on tripod directing the light downwards.

Pair of RX 7s 70W MH DE lamp/pair of RX 7s-24 150W MH DE lamp holder, open construction ballast and accessories are wired up to the terminal block.

Suitable upto 70 mm OD pipe entry with fixing bolts.

Ingress protection : IP 54

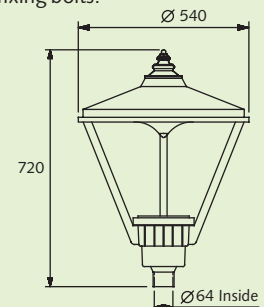

**BRIL 22 70/150 MH DE**



# Urban Architecture Lighting



BJCPTI 111/118 C

## Renaissance - Post Top Lantern

### Applications

Resorts & Townships, Pathways, City Centres, Gardens and Precincts.

### Specification

Integral post top lantern comprises of black outside and white inside painted spun aluminium canopy, funnel shape clear acrylic cover and black ABS plastic spigot housing.

Canopy and Spigot are painted black.

Single G 23 for 11W/G 24d-2 for 18W CFL lamp holder, open construction ballast are wired up to the terminal block.

Cross baffles are provided inside around the lamp to reduce the glare.

Ingress protection : IP 43

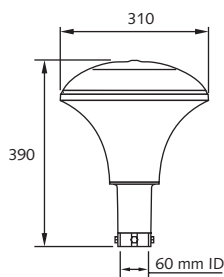

BJCPTI 111/118 C



BJCPTI 111/118 O

## Renaissance - Post Top Lantern

### Applications

Resorts & Townships, Pathways, City Centres, Gardens and Precincts.

### Specification

Integral post top lantern comprises of black outside and white inside painted spun aluminium canopy, funnel shape opal acrylic cover and black ABS plastic spigot housing.

Canopy and Spigot are painted black.

Single G 23 for 11W/G 24d-2 for 18W CFL lamp holder, open construction ballast are wired up to the terminal block.

Ingress protection : IP 43

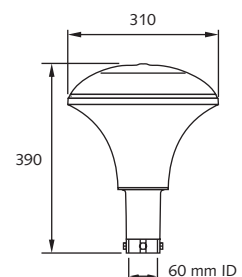

BJCPTI 111/118 O





## BJCPTI 211/218 C

### Renaissance - Post Top Lantern

#### Applications

Resorts & Townships, Pathways, City Centres, Gardens and Precincts.

#### Specification

Integral post top lantern comprises of black outside and white inside painted spun aluminium canopy, funnel shape clear acrylic cover and a ABS plastic spigot housing.

Canopy and Spigot are painted black.

Twin G 23 for 11W/G 24d-2 for 18W CFL lamp holder, open construction ballast are wired up to the terminal block.

Cross baffles are provided inside around the lamp to reduce the glare.

Ingress of protection : IP 43

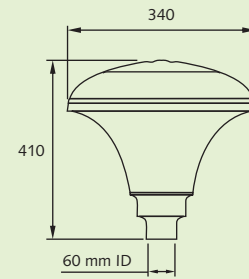

BJCPTI 211/218 C



# Urban Architecture Lighting



**BJCPTI 211/218 O**

## Renaissance - Post Top Lantern

### Applications

Resorts & Townships, Pathways, City Centres, Gardens and Precincts.

### Specification

Integral post top lantern comprises of black outside and white inside painted spun aluminium canopy, funnel shape opal acrylic cover and a cast aluminium spigot housing.

Canopy and Spigot are painted black.

Twin G 23 for 11W/G 24d-2 for 18W CFL lamp holder, open construction ballast are wired up to the terminal block.

Ingress protection : IP 43

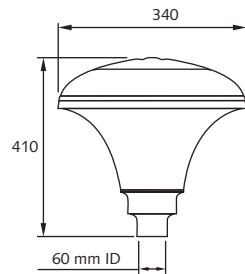

**BJCPTI 211/218 O**



**BJGLI 211**

## Renaissance - Post Top Lantern

### Applications

Resorts & Townships, Pathways, City Centres, Gardens and Precincts.

### Specification

Integral post top lantern comprises of black outside and white inside painted canopy, funnel shape clear acrylic cover and a black ABS plastic spigot housing.

Cross baffles are provided around the lamp to reduce glare in clear version

Light opening is provided on main canopy with acrylic cover.

Twin G 23 for 11W CFL lamp holder, open construction ballast are wired up to the terminal block.

Suitable for 50 mm OD pipe entry with fixing bolts.

Ingress protection : IP 54

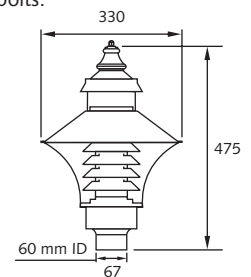

**BJGLI 211**





## BRPTI 111/118 C/O

### Renaissance - Post Top Lantern

#### Applications

Resorts & Townships, Pathways, City Centres, Gardens and Precincts.

#### Specification

Integral post top lantern comprises of black outside and white inside painted canopy, clear/opal acrylic cover and a black ABS plastic spigot housing.

Cross baffles are provided around the lamp to reduce glare in clear version.

Single G 23 for 11W and G 24d-2 for 18W CFL lamp holder, open construction ballast are wired up to the terminal block.

Suitable for 50 mm OD pipe entry with fixing bolts.

Ingress protection : IP 54

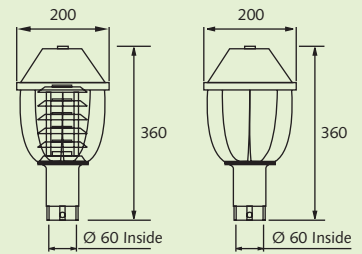

BRPTI 111/118 C

BRPTI 111/118 O



# Urban Architecture Lighting



BRPTCI 111/118 C/O

## Renaissance - Post Top Lantern

### Applications

Resorts & Townships, Pathways, City Centres, Gardens and Precincts.

### Specification

Integral post top lantern comprises of Fedora shape black outside and white inside painted canopy, fedora hat shape clear/opal acrylic cover and a black ABS plastic spigot housing.

Single G 23 for 11W and G 24d-2 for 18W CFL lamp holder, open construction ballast are wired up to the terminal block.

Suitable for 50 mm OD pipe entry with fixing bolts.

Ingress protection : IP 54.

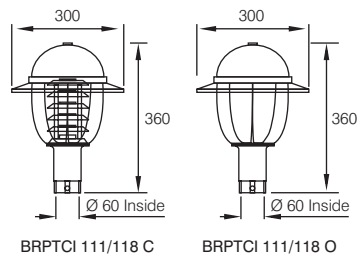

BRPTCI 111/118 C

BRPTCI 111/118 O



BJPTI 80/125 MV /70SV

## Renaissance - Post Top Lantern

### Applications

Resorts & Townships, Pathways, City Centres, Gardens and Precincts.

### Specification

Integral post top lantern comprises of black cast aluminium spigot, Black outside, white inside painted spun aluminium canopy fixed with opal acrylic diffuser.

E27 lamp holder for 80/125W HPMV / 70W HPSV lamp, open construction ballast and accessories are wired up to the terminal block.

Bottom entry mounting for 60mm OD pipe bracket.

Ingress protection : IP 54

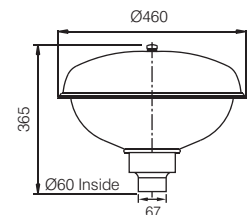

Note: BC lamp holder for 80/125W HPMV lamp are available on version.  
BJPTL- Non integral version available on request. Use appropriate control.





## BJDPTI 80/125 MV /70 SV/MH

### Renaissance - Post Top Lantern

#### Applications

Resorts & Townships, Pathways, City Centres, Gardens and Precincts.

#### Specification

Black painted die-cast aluminium alloy pole mounting spigot.

E27 lamp holder for 80/125W HPMV / 70W HPSV lamp, open construction ballast and accessories are wired up to the terminal block.

Diamond shape UV stabilised roto mould diffuser is fixed against the spigot by pressure plate.

Bottom entry mounting for 50 mm OD pipe bracket.

HPF version available on request.

Ingress protection : IP 54

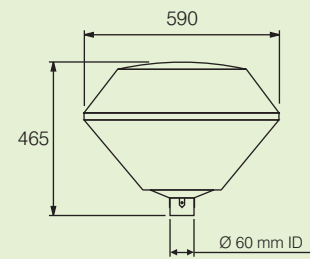

# Urban Architecture Lighting



**BJMPTI 80/125 MV/ 70 SV/MH**

## Renaissance - Post Top Lantern

### Applications

Resorts & Townships, Pathways, City Centres, Gardens and Precincts.

### Specification

Black painted die-cast aluminium alloy pole mounting spigot.

E27 lamp holder for 80/125W HPMV / 70W HPSV lamp, open construction ballast and accessories are wired up to the terminal block.

Mushroom shape UV stabilised roto mould diffuser is fixed against the spigot by pressure plate.

Bottom entry mounting for 50 mm OD pipe bracket.

HPF version available on request.

Ingress protection : IP 54

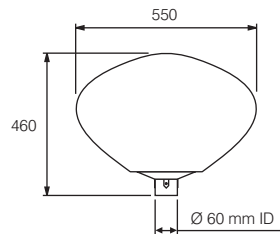

**BJSPTI 8/125 MV /70 SV/MH**

## Renaissance - Post Top Lantern

### Applications

Resorts & Townships, Pathways, City Centres, Gardens and Precincts.

### Specification

Black painted die-cast aluminium alloy pole mounting spigot.

E27 lamp holder for 80/125W HPMV / 70W HPSV lamp, open construction ballast and accessories are wired up to the terminal block.

Spherical shape UV stabilised roto mould diffuser is fixed against the spigot by pressure plate.

Bottom entry mounting for 50 mm OD pipe bracket.

HPF version available on request.

Ingress protection : IP 54

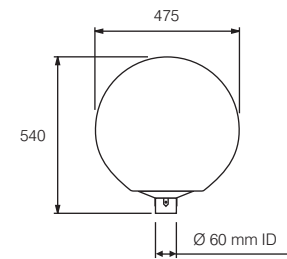



BJTPTI 80/125 MV  
BJTPTI 70 SV/MH

### Renaissance - Post Top Lantern

#### Applications

Resorts & Townships, Pathways, City Centres, Gardens and Precincts.

#### Specification

Black painted die-cast aluminium alloy pole mounting spigot.

E27 lamp holder for 80/125W HPMV / 70W HPSV lamp, open construction ballast and accessories are wired up to the terminal block.

Temple shape UV stabilised roto mould diffuser is fixed against the spigot by pressure plate.

Bottom entry mounting for 50 mm OD pipe bracket.

HPF version available on request.

Ingress protection : IP 54

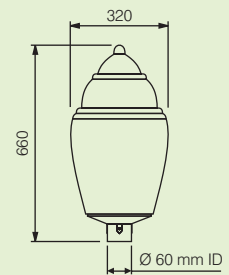

# Urban Architecture Lighting



BJODC 1170 SV/MH - JUNO  
BJODC 1170 MH DE - JUNO

## JUNO - Non Integral Post Top Lantern

### Applications

Public areas, Parks & Gardens, Pedestrian precincts, Road junctions, Residential blocks and Entrance gates, etc.

### Specification

Non integral post top lantern comprises of spun aluminium copper dust finish canopy, cast aluminium alloy spigot housing.

UV stabilised clear acrylic diffuser fixed to spigot and canopy.

E 27 lamp holder for 70W HPSV/MH SE lamp, pair of Rx 7s lamp holder for 70W MH DE lamp are wired up to the terminal block.

Bottom entry mounting for 60mm OD pipe

Ingress protection : IP 54

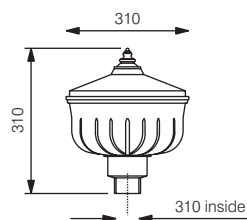

Note : Use separate control gears suitable for respective lamp.



BJODC 150 SV/MH JUNO  
BJODC 150 MH DE - JUNO

## JUNO - Non Integral Post Top Lantern

### Applications

Public areas, Parks & Gardens, Pedestrian precincts, Road junctions, Residential blocks and Entrance gates, etc.

### Specification

Non integral post top lantern comprises of spun aluminium copper dust finish canopy, cast aluminium alloy spigot housing.

UV stabilised clear acrylic diffuser fixed to spigot and canopy.

E 40 lamp holder for 150W HPSV/MH SE lamp, pair of Rx 7s-24 lamp holder for 150W MH DE lamp are wired up to the terminal block.

Bottom entry mounting for 60mm OD pipe

Ingress protection : IP 54

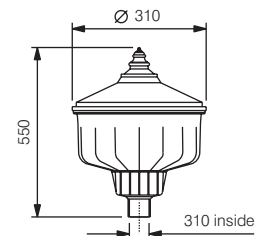

Note : Use separate control gears suitable for respective lamp.





**BJODC 250 SV/MH - JUNO**  
**BJODC 400 MH - JUNO**

**JUNO - Non Integral Post Top Lantern**

**Applications**

Resorts & Townships, Pathways, City Centres, Gardens and Precincts, etc.

**Specification**

Non integral post top lantern comprises of spun aluminium copper dust finish canopy, cast aluminium alloy spigot housing.

UV stabilised clear acrylic diffuser fixed to spigot and canopy.

E 40 lamp holder for 250W/400W HPSV/MH lamp, are wired up to the terminal block.

Bottom entry mounting for 60mm OD pipe

Ingress protection : IP 54

Note :  
use separate control gears suitable for respective lamp.

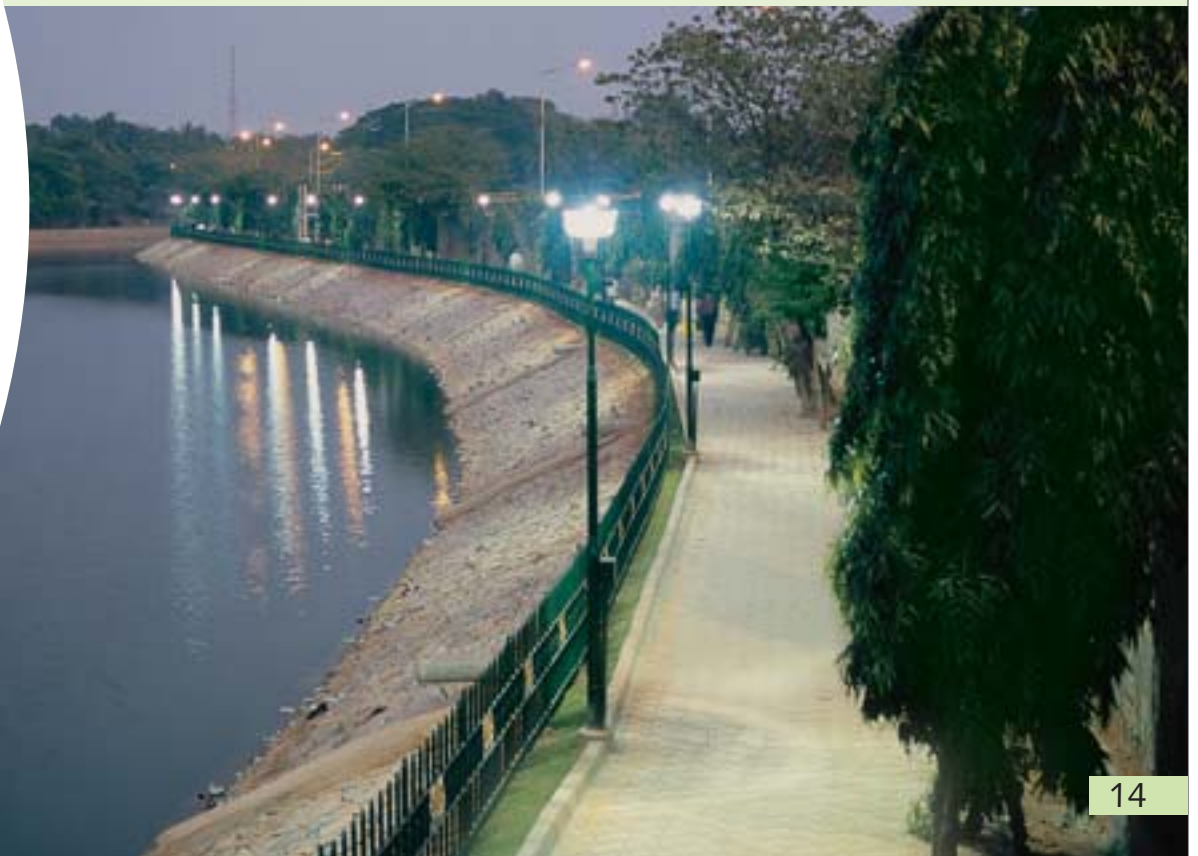
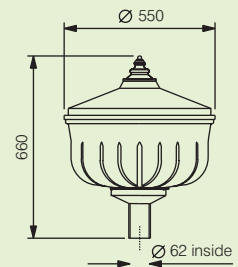

# Urban Architecture Lighting



BJODC 3x1170 SV/MH  
BJODC 3x1170 MH DE  
(Triple Juno)



BJODC 3x150 SV/MH  
BJODC 3x150 MH DE  
(Triple Juno)

## JUNO - Non Integral Post Top Lantern

### Applications

Public areas, Parks & Gardens, Pedestrian precincts, Road junctions, Residential blocks and Entrance gates, etc.

### Specification

Non integral post top lantern comprises of spun aluminium copper dust finish canopy, cast aluminium alloy spigot housing.

UV stabilised clear acrylic diffuser fixed to spigot and canopy.

E 27 lamp holder for 70W HPSV/MH SE lamp, pair of Rx 7s lamp holder for 70W MH DE lamp are wired up to the terminal block.

3 nos. BJODC 1170 SV/MH/70 MH DE and three "J" shape pipe installed on center assembly with bolts and nuts.

Central pipe assembly Bottom entry mounting for 75mm OD pipe

Ingress protection : IP 54

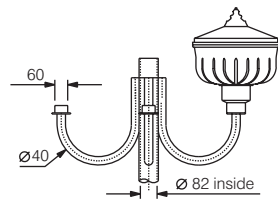

Note: Use separate control gears suitable for respective lamp.

## JUNO - Non Integral Post Top Lantern

### Applications

Public areas, Parks & Gardens, Pedestrian precincts, Road junctions, Residential blocks and Entrance gates, etc.

### Specification

Non Integral Post Top Lantern comprises of spun aluminium copper dust finish canopy, cast aluminium alloy spigot housing.

UV stabilised clear acrylic diffuser fixed to spigot and canopy.

E 40 lamp holder for 150W HPSV/MH SE lamp, pair of Rx 7s-24 lamp holder for 150W MH DE lamp are wired up to the terminal block.

3 nos. BJODC 150 SV/MH/150 MH DE and three "J" shape pipe installed on center assembly with bolts and nuts.

Bottom entry mounting for 75mm OD pipe

Ingress protection : IP 54

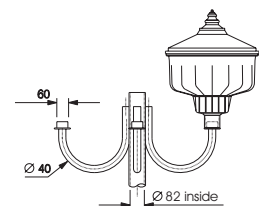

Note: Use separate control gears suitable for respective lamp.





## BJODC 3X250 SV/MH-TRIPLE JUNO BJODC 3X400 MH-TRIPLE JUNO

### JUNO - Non Integral Post Top Lantern

#### Applications

Resorts & Townships, Pathways, City Centres, Gardens and Precincts, etc.

#### Specification

Non integral post top lantern comprises of spun aluminium copper dust finish canopy, cast aluminium alloy spigot housing.

UV stabilised clear acrylic diffuser fixed to spigot and canopy.

E 40 lamp holder for 250W/400W HPSV/MH lamp, are wired up to the terminal block.

3 nos. BJODC 250SV/MH/400 MH and three "J" shape pipe installed on center assembly with bolts and nuts.

Bottom entry mounting for 75mm OD pipe

Ingress protection : IP 54

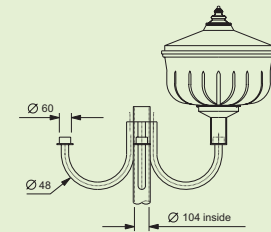

Note : Use separate control gears suitable for respective lamp.



# Urban Architecture Lighting



BJODCI 1170 SV/MH (Juno)  
BJODCI 1170 MH DE (Juno)

## JUNO - Integral Post Top Lantern

### Applications

Public areas, Parks & Gardens, Pedestrian precincts, Road junctions, Residential blocks and Entrance gates, etc.

### Specification

Integral post top lantern comprises of spun aluminium copper dust finish canopy, cast aluminium alloy spigot housing.

UV stabilised clear acrylic diffuser fixed to spigot and canopy.

E 27 lamp holder for 70W HPSV/MH SE lamp, pair of Rx 7s lamp holder for 70W MH DE lamp, open construction ballast are wired up to the terminal block.

Bottom entry mounting for 60mm OD pipe

Ingress protection : IP 54

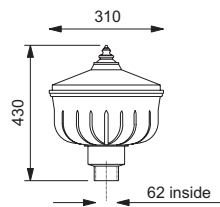

BJODCI 150 SV/MH (Juno)  
BJODCI 150 MH DE (Juno)

## JUNO - Integral Post Top Lantern

### Applications

Public areas, Parks & Gardens, Pedestrian precincts, Road junctions, Residential blocks and Entrance gates, etc.

### Specification

Integral Post Top Lantern comprises of spun aluminium copper dust finish canopy, cast aluminium alloy spigot housing.

UV stabilised clear acrylic diffuser fixed to spigot and canopy.

E 40 lamp holder for 150W HPSV/MH SE lamp, pair of Rx 7s-24 lamp holder for 150W MH DE lamp, open construction ballast are wired up to the terminal block.

Bottom entry mounting for 60mm OD pipe

Ingress protection : IP 54

Note :  
use separate control gears suitable for respective lamp.

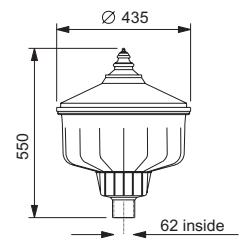



**BJODCI 250 SV/MH (Juno)**  
**BJODCI 400 MH (Juno)**

**JUNO - Integral Post Top Lantern**

**Applications**

Resorts & Townships, Pathways, City Centres, Gardens and Precincts, etc.

**Specification**

Integral post top Lantern comprises of spun aluminium copper dust finish canopy, cast aluminium alloy spigot housing.

UV stabilised clear acrylic diffuser fixed to spigot and canopy.

E40 lamp holder for 250W HPSV/MH / 400W MH lamp, open construction / potted ballast are wired up to the terminal block.

Bottom entry mounting for 60mm OD pipe

Ingress protection : IP 54

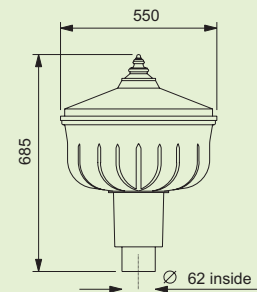

Note : 400W HPSV/MH ballast shall be supplied in potted version only..



# Urban Architecture Lighting



**BIODCI 3X 1170 SV/MH  
BIODCI 3X 1170 MH DE  
(Triple Juno)**



**BIODCI 3X150 SV/MH  
BIODCI 3X150 MH DE  
(Triple Juno)**

## JUNO - Integral Post Top Lantern

### Applications

Public areas, Parks & Gardens, Pedestrian precincts, Road junctions, Residential blocks and Entrance gates, etc.

### Specification

Integral post top lantern comprises of spun aluminium copper dust finish canopy, cast aluminium alloy spigot housing.

UV stabilised clear acrylic diffuser fixed to spigot and canopy.

E 27 lamp holder for 70W HPSV/MH SE lamp, pair of Rx 7s lamp holder for 70W MH DE lamp are wired up to the terminal block.

3 nos. BJODC 70SV/MH/70MH DE and three "J" shape pipe installed on center assembly with bolts and nuts.

Bottom entry mounting for 75mm OD pipe

Ingress protection : IP 54

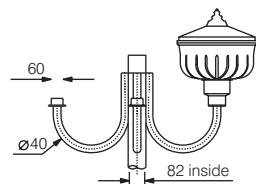

## JUNO - Integral Post Top Lantern

### Applications

Public areas, Parks & Gardens, Pedestrian precincts, Road junctions, Residential blocks and Entrance gates, etc.

### Specification

Integral Post Top Lantern comprises of spun aluminium copper dust finish canopy, cast aluminium alloy spigot housing.

UV stabilised clear acrylic diffuser fixed to spigot and canopy.

E 40 lamp holder for 150W HPSV/MHSE lamp, pair of Rx 7s-24 lamp holder for 150W MHDE lamp are wired up to the terminal block.

3 nos. BJODC 150SV/MH/150MH DE and three "J" shape pipe installed on center assembly with bolts and nuts.

Bottom entry mounting for 75mm OD pipe

Ingress protection : IP 54

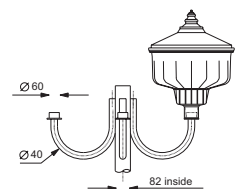

BJODCI 3x250 SV/MH  
BJODCI 3x400 MH  
(Triple Juno)



**JUNO - Integral Post Top Lantern**

**Applications**

Resorts & Townships, Pathways, City Centres, Gardens and Precincts, etc.

**Specification**

Integral Post Top Lantern comprises of spun aluminium copper dust finish canopy, cast aluminium alloy spigot housing.

UV stabilised clear acrylic diffuser fixed to spigot and canopy.

E 40 lamp holder for 250W/400W HPSV/MH lamp, are wired up to the terminal block.

3 nos. BJODC 250SV/MH/400MH and three "J" shape pipe installed on center assembly with bolts and nuts.

Bottom entry mounting for 75mm OD pipe

Ingress protection : IP 54

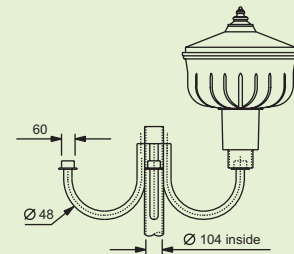

Note : 400W HPSV/MH ballast shall be supplied in potted version only..



# Urban Architecture Lighting



**BRSGL 70 SV/MH (12")**



**BRSGL 150/250/400 SV/MH (19")**

## Decorative Roadway Luminaire

### Applications

Resorts & Townships, Pathways, City Centres, Gardens and Precincts, etc.

### Specification

Integral, pole mount decorative roadway luminaire comprises of black painted spun aluminium top cover fixed to circular ring, clear acrylic cover fixed at bottom.

Electrochemically brightened, computer aided designed pot optic aluminium reflector for tubular lamp.

E27 lamp holder suitable 70 W HPSV/MH lamp, open construction ballast and accessories are wired up to the terminal block.

Black painted pole mounting attachment fixed to circular ring suitable for 50mm OD piped.

Ingress protection : IP 55

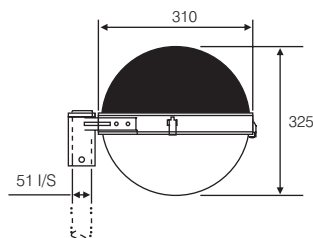

Note: BRSGL range is also available with top mounting version on request. MH luminaire can be supplied with clean toughened glass on request.

## Renaissance - Decorative Roadway Luminaire

### Applications

Resorts & Townships, Pathways, City Centres, Gardens and Precincts.

### Specification

Integral, pole mount decorative roadway luminaire comprises of black painted spun aluminium top cover fixed to circular ring, clear acrylic cover fixed at bottom.

Electrochemically brightened, computer aided designed pot optic aluminium reflector for tubular lamp.

E40 lamp holder suitable for 150/250/400 HPSV/MH, open construction/potted ballast and accessories are wired up to the terminal block.

Black painted pole mounting attachment fixed to circular ring suitable for 50mm OD piped.

Ingress protection : IP 55

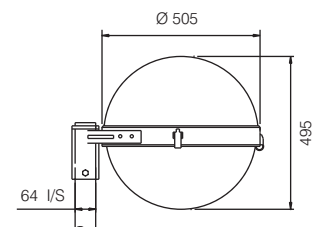



## BRSGL 150/250/400 SV/MH TM

### Renaissance - Decorative Roadway Luminaire

#### Applications

Resorts & Townships, Pathways, City Centres, Gardens and Precincts.

#### Specification

Integral, top mounting decorative roadway luminaire comprises of black painted spun aluminium top cover fixed to circular ring, clear acrylic cover fixed at bottom.

Electrochemically brightened, computer aided designed pot optic aluminium reflector for tubular lamp.

E40 lamp holder suitable for 150/250/400 HPSV/MH, open construction/potted ballast and accessories are wired up to the terminal block.

Ingress protection : IP 55

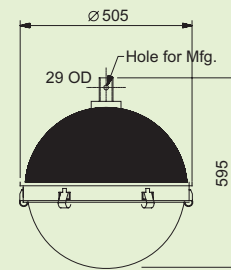

# Urban Architecture Lighting



BECBL 02 118/126 CFL

## Le Magique - Bollard

### Applications

Pathways, Townships and Gardens.

### Specification

Integral bollard comprises of silver grey powder coated finish cylindrical shape having die-cast aluminium top cover fixed with clear acrylic cover.

Cross baffles are provided around the lamp to reduce glare.

G24d-2 lamp holder for 18/26 W CFL lamp, open construction ballast are wired up to the terminal block.

Ingress protection : IP 54

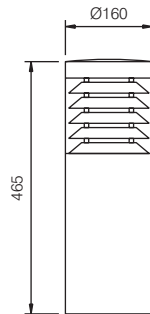

Note: Luminaire shall be supplied with 35/70W CDMT lamp on request.



BECBL 01 118/126 CFL

## Le Magique - Bollard

### Applications

Pathways, Townships and Gardens.

### Specification

Integral bollard comprises of silver grey powder coated finish cylindrical shape having die-cast aluminium top cover fixed with clear acrylic cover.

Cross baffles are provided around the lamp to reduce glare.

G24d-2 lamp holder for 18/26 W CFL lamp, open construction ballast are wired up to the terminal block.

Ingress protection : IP 54

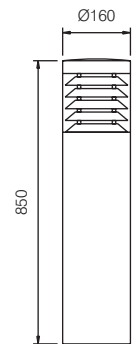

Note: Luminaire shall be supplied with 35/70W CDMT lamp on request.





## BRBOL 111/118

### Renaissance - Bollard

#### Applications

Pathways, Townships and Gardens.

#### Specification

Integral bollard comprises of green painted cylindrical shape housing, spun aluminium "Fedora" hat shape top cover fixed with clear acrylic cover.

Cross baffles are provided around the lamp to reduce glare.

G23 lamp holder for 11W CFL/G24 d-2 lamp holder for 18W CFL lamp, open construction ballast are wired up to the terminal block.

Ingress protection : IP 54

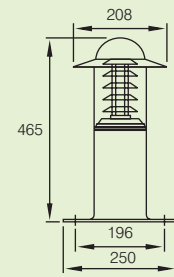

BRBOL 111/118



# Urban Architecture Lighting



**BRBODC 111/118**

## Renaissance - Bollard

### Applications

Pathways, Townships and Gardens.

### Specification

Integral bollard comprises of green painted cylindrical shape housing, spun aluminium top cover with light opening, UV stabilized acrylic bowl with ribs.

Cross baffles plates around the lamp to reduce glare.

G23 for 11W and G24d-2 for 18W lamp holder, open construction ballast wired up to the terminal block.

Base plate with fixing holes for direct mounting

Ingress protection : IP 54

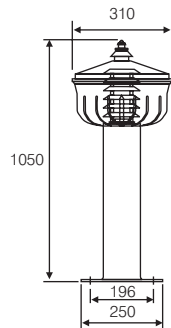

**BJBOL 02 29/213/218**

## Renaissance - Bollard Luminaire

### Applications

Pathways, Townships and Gardens.

### Specification

Integral bollard comprises of Black painted seamless cylindrical shape housing, cast aluminium dome shape top cover, fixed with cylindrical shape needed poly carbonate cover.

Twin G-23 lamp holder for 9/13W CFL lamp, G-24 d-2 lamp holder for 18W CFL lamp, open construction ballast are wired up to the terminal block.

Base plate and fixing holes for direct mounting.

Ingress protection : IP 43

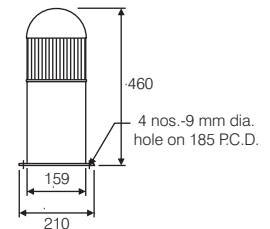

Note: Green colour version available on request.





## JBOL 03 29/213/218

### Renaissance - Bollard

#### Applications

Pathways, Townships and Gardens.

#### Specification

Integral bollard comprises of green painted seamless cylindrical shape housing, cast aluminium dome shape top cover, fixed with cylindrical shape needed poly carbonate cover.

Twin G-23 lamp holder for 9/13W CFL lamp, G-24 d-2 lamp holder for 18W CFL lamp, open construction ballast are wired up to the terminal block.

Base plate and fixing holes for direct mounting.

Ingress protection : IP 43

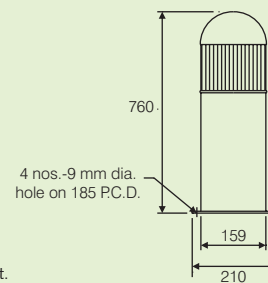

Note: Green colour version available on request.



# Urban Architecture Lighting



BLWUD 23 PAR

## Le Magique - Wall Light

### Applications

Column lighting, Semi-outdoor corridors, Building facades, Entrance areas and Auditorium.

Pillar lighting, Wall washer, Up down lighting in commercial premises

### Specification

Integral up-down lighter comprises of black painted housing, enclosed with glass cover in frame.

Electrochemically anodised aluminium reflector.

Cast aluminium wall mounting bracket fixed to the housing.

E27 lamp holder suitable for GLS/ Retrofit CFL lamp wired to the terminal block.

Ingress protection : IP 44

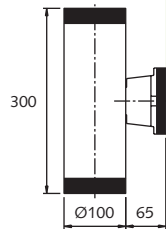

BLWUD 23 PAR



BEUDL 35/70 CDMT

## Le Magique - Wall Light

### Applications

Column lighting, Semi-outdoor corridors, Building facades, Entrance areas and Auditorium.

Pillar lighting, Wall washer, Up down lighting in commercial premises

### Specification

Integral up-down lighter luminaire comprises of black painted housing, enclosed with glass cover in frame.

Electrochemically anodised aluminium reflector.

Cast aluminium wall mounting bracket fixed to the housing.

G12 lamp holder suitable for 35/70W CDMT lamp, electronic ballast are wired upto the terminal block.

Ingress protection : IP 65

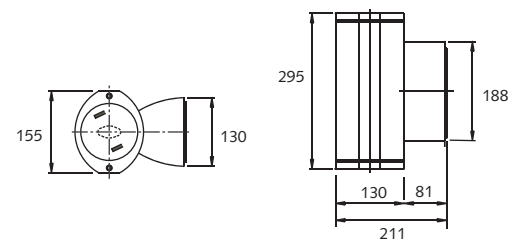

BEUDL 35/70 CDMT



**BEOPL 113/118 CFL**  
**BEGPL 113/118 CFL**



**Le Magique - Step Light**

**Applications**

Auditoriums, Walkways, Corridors, Offices, Malls and Multiplexes.

**Specification**

Integral step light luminaires comprises of white powder coated cast aluminium housing,

Black powder coated cast aluminium frame cover fixed to housing with frosted glass enclosure in BEOPL 113/118 CFL .

Black powder coated cast aluminium Grill cover fixed to housing with frosted glass enclosure in BEGPL 113/118 CFL .

G 24 d-2 lamp holder for 13/18W CFL lamp, open construction ballast are wired up to the terminal block.

Ingress protection : IP 43

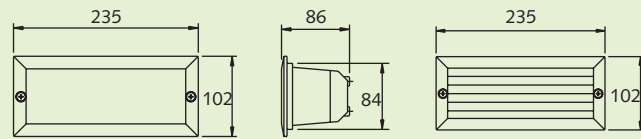

**BEOPL 113/118 CFL**

**BEGPL 113/118 CFL**



# Urban Architecture Lighting



BETBL 50 DH

## Le Magique - Walkover Luminaire

### Applications

Walkways, Parks, Gardens, Pedestrian lighting, Facade lighting and Monument lighting.

### Specification

Recess floor mounted polyster powder coated die-cast aluminium walk over luminaire.

Three way light opening top frame fixed with clear/opal glass fixed to the housing with allen screws - antiglare diffuse light.

GU-10 lamp holder for 50W DH lamp wired up to the terminal block.

Ingress protection : IP67

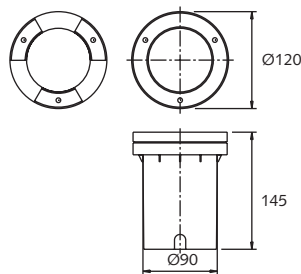

BETBL 50 DH



BEBL 50 DH

## Le Magique - Walkover Luminaire

### Applications

Walkways, Parks, Gardens, Pedestrian lighting, Facade lighting and Monument lighting.

### Specification

Recess floor mounted polyster powder coated die-cast aluminium walk over luminaire.

Top frame fixed with opal glass fixed to the housing with allen screws - antiglare diffuse light.

GU-10 lamp holder for 50W DH lamp wired up to the terminal block.

Ingress protection : 67

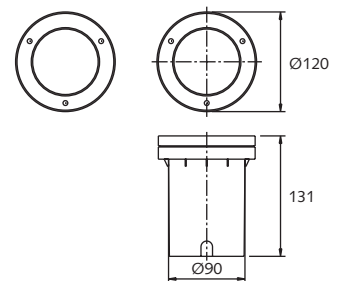

BEBL 50 DH



## BEGBL 50 DH



### Le Magique - Walkover Luminaire

#### Applications

Walkways, Parks, Gardens, Pedestrian lighting, Facade lighting and Monument lighting.

#### Specification

Recess floor mounted polyster powder coated die-cast aluminium walk over luminaire.

Anti glare grill top frame fixed with opal glass fixed to the housing with allen screws - antiglare diffuse light.

GU-10 lamp holder for 50W DH lamp wired up to the terminal block.

Ingress protection : IP 67

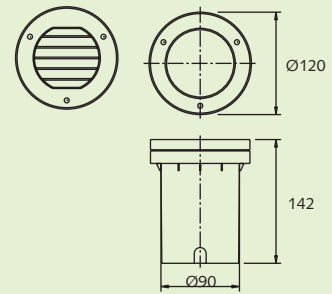

BEGBL 50 DH



# Urban Architecture Lighting



**BEPBL 50 DH**

## Le Magique - Walkover Luminaire

### Applications

Walkways, Parks, Gardens, Pedestrian lighting, Facade lighting and Monument lighting.

### Specification

Recess floor mounted polyster powder coated die-cast aluminium walk over luminaire.

Uni-directional top frame fixed with opal glass fixed to the housing with allen screws - antiglare diffuse light.

GU-10 lamp holder for 50W DH lamp wired up to the terminal block.

Ingress protection: IP 67

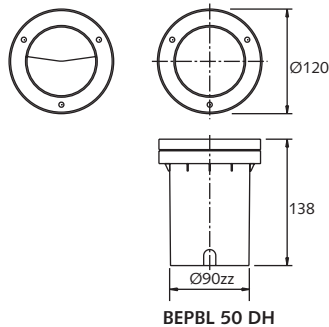

**BEPBL 50 DH**



**BEWOL 50 DH SS**

## Le Magique - Walkover Luminaire

### Applications

Walkways, Parks, Gardens, Pedestrian lighting, Facade lighting and Monument lighting.

### Specification

Recess floor mounted polyster powder coated die-cast aluminium walk over luminaire.

Stainless steel top frame fixed with opal glass fixed to the housing with allen screws - antiglare diffuse light.

GU-10 lamp holder for 50W DH lamp wired up to the terminal block.

Ingress protection : IP 67

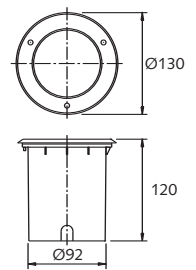

**BEWOL 50 DH SS**





**BEWOL 70 MH DE AL/SS/S**  
**BEWOL 70 MH DE AL/SS/AS**

**Le Magique - Walkover Luminaire**

**Applications**

Walkways, Parks, Gardens, Pedestrian lighting, Facade lighting and Monument lighting.

**Specification**

Integral walkover luminaire comprises of epoxy powder coated die-cast aluminium housing fixed with aluminium / stainless steel top ring, clear toughened glass with silicon rubber gasket and ss screws.

Electrochemically brightened anodized aluminium reflector suitable for symmetrical / asymmetrical beam application.

Pair of Rx7s lamp holder suitable 70W MH DE lamp, open construction ballast and accessories are wired up to the terminal block.

Ingress Protection : 67

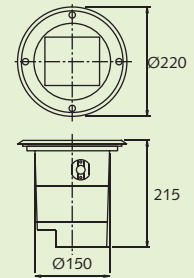

**BEWOL 70 MH DE AL/SS/S**  
**BEWOL 70 MH DE AL/SS/AS**

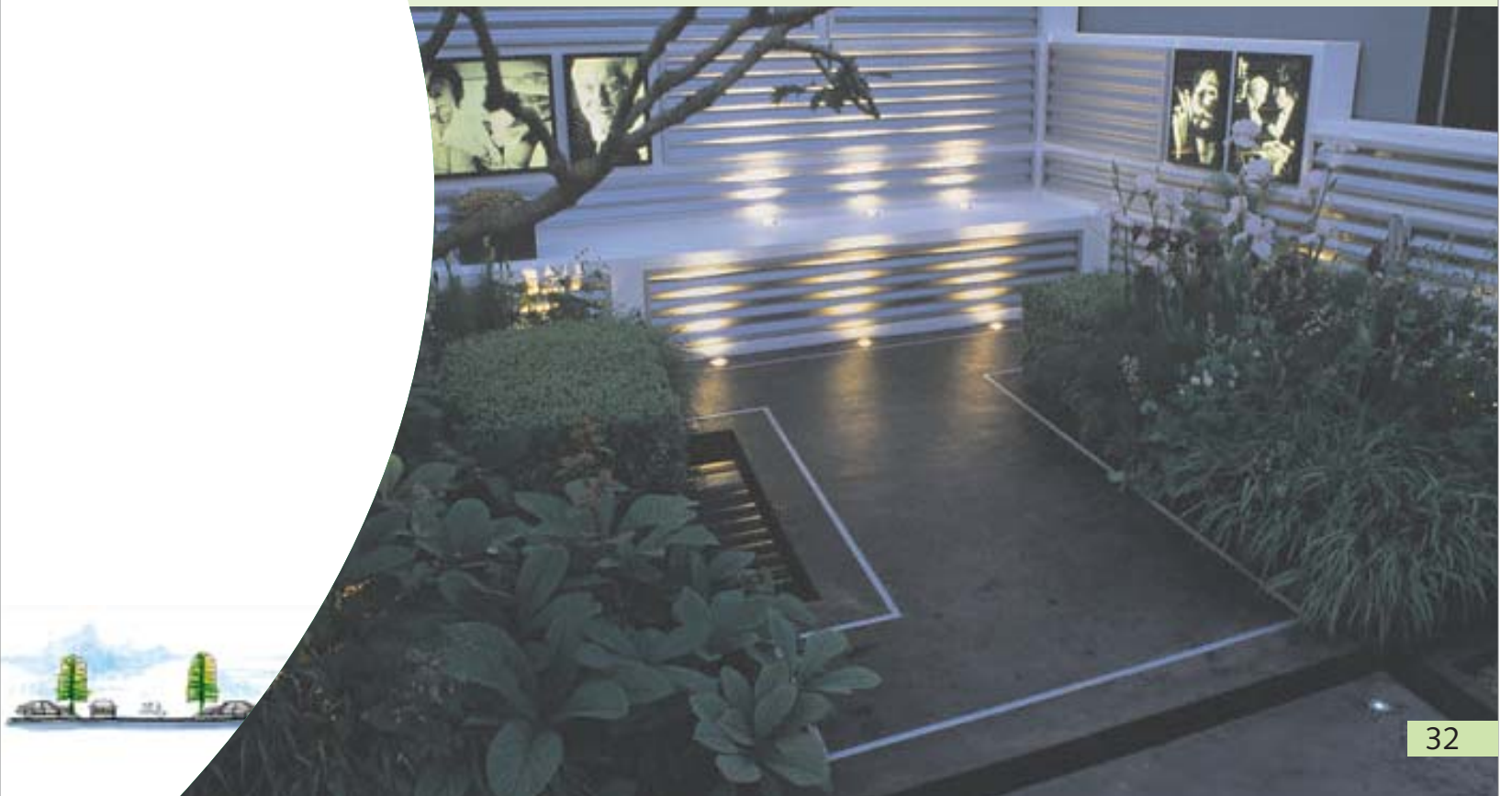

# Urban Architecture Lighting



**BRWOL 70/150 MH DE CA SQ**

## Le Magique - Walkover Luminaire

### Applications

Walkways, Parks, Gardens, Pedestrian lighting, Facade lighting and Monument lighting.

### Specification

Integral walkover luminaire comprises of black powder coated die-cast aluminium housing, fixed with silicon rubber gasket, clear toughened glass with square die-cast aluminium frame.

Electrochemically polished symmetrical beam aluminum reflector.

Pair of Rx7s lamp holder suitable for 70W MHDE / pair of Rx 7s-24 lamp holder suitable for 150W MHDE, open construction ballast and accessories are wired up to the terminal block.

Ingress protection : IP 67

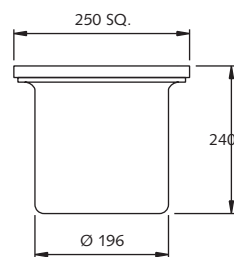

**BRWOL 70/150 MH DE CA SQ**



**BRWOL 150 MH SE**

## Le Magique - Walkover Luminaire

### Applications

Walkways, Parks, Gardens, Pedestrian lighting, Facade lighting and Monument lighting.

### Specification

Integral walkover luminaire comprises of black powder coated die-cast aluminium housing, fixed with silicon rubber gasket, clear toughened glass with square die-cast aluminium frame.

Electrochemically polished symmetrical beam aluminum reflector / asymmetrical beam aluminium reflector.

Pair of Rx 7s-24 lamp holder suitable for 150W MHDE, open construction ballast and accessories are wired up to the terminal block.

Ingress protection : IP 67

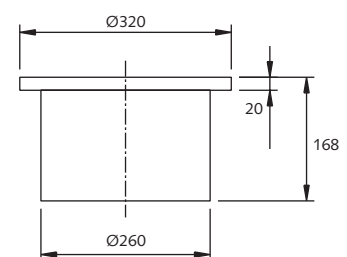

**BRWOL 150 MH SE**





## BEUWL 150 DH

### Le Magique - Underwater Luminaire

#### Applications

Swimming pools, Fountains and Water bodies.

#### Specification

Non-Integral under water luminaire comprises of gun metal housing, brass finish, fixed with rubber gasket, clear toughened glass in round frame.

This underwater luminaire when submerged in water, the water head should not exceed 0.6 meter or 2ft. approx.

G5,4 lamp holder suitable for 50W dichroic lamp wired upto the terminal block.

Ingress protection : IP 68

Note: Use separate 230/12V transformer for operating 50W 12V dichroic lamp and the transformer must be located away from the water body.

Under water shall be supplied with 3W LED on request.

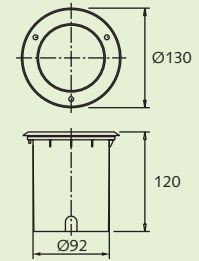

BEUWL 150 DH



# Urban Architecture Lighting



**BESBL 150 DH**



**BESGBL 150 DH**



**BEBHL 150 PAR16**

## Le Maqique - Bush Light

### Applications

Gardens, Parks, Ground signboards, Monument lighting and Sculpture lighting.

### Specification

Bush light comprises of Polyester black powder coated die cast aluminium with spike to install.

BESBL/BESGBL 150 DH is provided with shield for guiding the light.

E27 lamp holder suitable for 50W DH lamp, accessories are wired upto the terminal block.

Ingress protection : 67

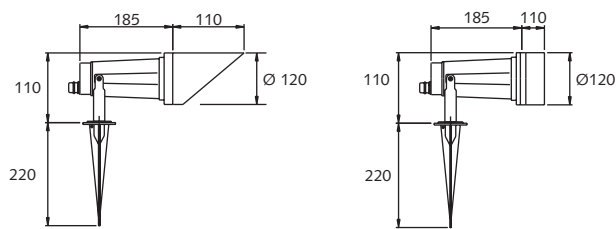

**BESBL 150 DH**

**BESGBL 150 DH**

Note: BESBL 150DH suitable for uniform light distribution,  
BESGBL 150DH suitable for guided light distribution,

## Le Maqique - Bush Lighting

### Applications

Gardens, Parks, Ground signboards, Monument lighting and Sculpture lighting.

### Specification

Bush light comprises of Polyester black powder coated die cast aluminium with spike to install.

E27 lamp holder suitable for 50W DH lamp, accessories are wired upto the terminal block.

Ingress protection : 67

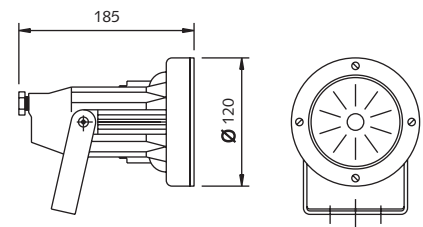

**BEBHL 150 PAR16**





## BEFL 70/150 MH DE

### Le Maquette - Wall Light

#### Applications

Entrance areas, Corridors, Building columns and Facades.

#### Specification

Decorative integral flood light luminaire comprise of polyester powder coated cast aluminium housing that can be mounted on a wall for an aesthetic appeal.

High resistance techopolymer cover fastened to the housing with silicon seal and steel screws - easy to install & maintain.

Specially designed mounting bracket to aim the object between 90° to 135°.

Pair of Rx7s-24 lamp holder suitable for 150W MHDE, open construction ballast and accessories are wired up to the terminal block.

Ingress protection : IP 66

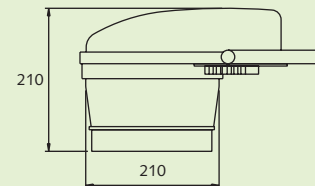

BEFL 70/150 MH DE



# Urban Architecture Lighting

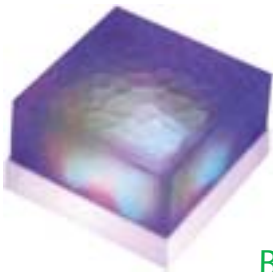

**BEBCL 06 045 LED W/R/G/B**

## Le Magique - Walkover Luminaire

### Applications

Walkways, Parks, Gardens, Pedestrian lighting.

### Specification

Extra thick tempered rough surface glass housing - Slip proof superior finish and long lasting.

LED lamp and electronic components embedded in resin to ensure total waterproofness.

Separate control gear BEBCLTR 24W 24VDC is required to operate max 4 numbers BEBCL 06 045 LED W/R/G/B Luminaire.

Ingress protection : IP 68

Suffix in luminaire Cat Ref. W-White, R-Red, G-Green, B-Blue

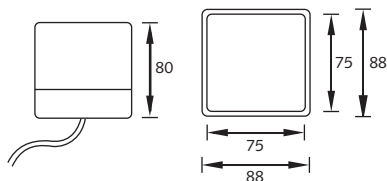

**BEBCL 06 045 LED W/R/G/B**



**BRRL 150/250/400 SV/MH  
"Borage"**

## Green - Decorative Roadway Lighting Luminaire

### Applications

Parks and gardens ,Pathways , Landscape lighting, Pedestrian crossing, etc.

### Specification

Integral decorative roadway lighting luminaire comprises of black painted cast aluminium C.G.housing with top mounting arrangement.

Black painted deep drawn aluminium housing for lamp & reflector assembly enclosed with UV stabilised clear polycarbonate cover.

Electrochemically brightened, computer aided designed pot optic aluminium reflector for tubular lamp

E40 lamp holder suitable for 150/250/400 SV/MH lamp, open construction/potted ballast, accessories are wired upto the terminal block.

Ingress Protection : IP 66 for lamp housing,

IP 55 for CG housing

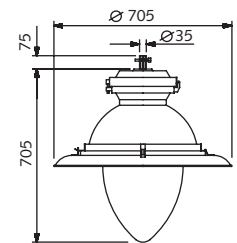

**BRRL 150/250/400 SV/MH**





## BRPRL 70/150 SV/MH "Marigold"

Green - Decorative post top lantern luminaire

### Applications

Resorts, Townships, Pathways, city centers etc.

### Specification

Integral decorative post top lantern comprises of black painted cast aluminium housing installed in "Y" shape designed bracket.

Black painted deep drawn aluminium housing for lamp & reflector assembly enclosed with UV stabilised clear polycarbonate cover.

E27 lamp holder suitable for 70/150 SV/MH lamp, open construction ballast are wired upto the terminal block.

Ingress Protection : IP 66 for lamp housing, IP 55 for CG housing

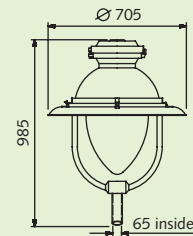

Note: BRPRL is also available with  
70/150W CDMT lamp on request.

BRPRL 70/150 SV/MH



# Urban Architecture Lighting

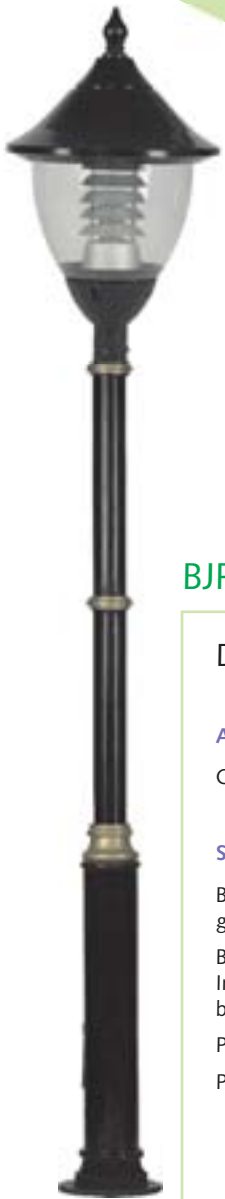

**BJPL 01 300/400/500/600/700/800**

## Designer Poles

### Applications

Gardens lighting, path lighting.

### Specification

Black painted galvanised pole in different cross section with gold colour painted decorative cast aluminium rings.

Base plate is welded to pole with 4 numbers mounting holes  
Integral connector block for loop in loop out is flushed in bottom section of the pole.

Poles are available in 3 /4/5/6/7 & 8 mtrs.

Poles are suitable for Juno and Neo range.

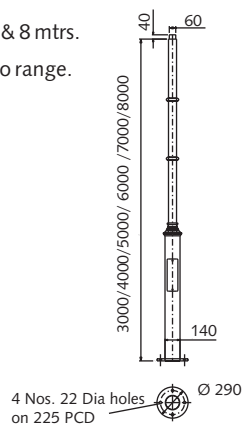

**BJPL 02 300/400/500/600/700/800**

## Designer Poles

### Applications

Gardens lighting, path lighting.

### Specification

Black painted galvanised pole in different cross section with gold colour painted decorative cast aluminium rings.

Base plate is welded to pole with 4 numbers mounting holes  
Integral connector block for loop in loop out is flushed in bottom section of the pole.

Base plate is covered with designed cast aluminium ring at base.

Poles are available in 3 /4/5/6/7 & 8 mtrs.

Poles are suitable for Juno and Neo range.

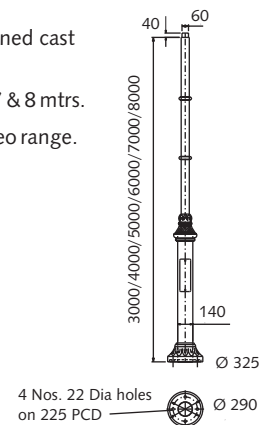



## BJPL 04 300/500/650

### Designer Poles

#### Applications

Resorts, Townships, Pathways, city centers etc.

#### Specification

Black painted galvanised pole in different cross section with gold colour painted decorative cast aluminium rings.

Gold colour finish designed cast aluminium base is fixed to the mail pole.

Poles are available in 3 /5 & 6.5 mtrs.

Poles are suitable for Juno and Neo range.

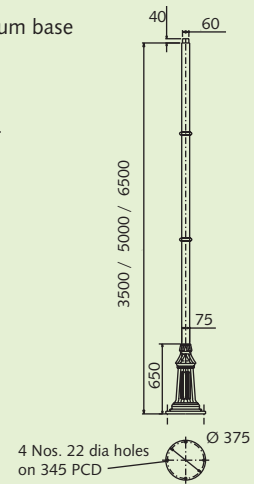

# Urban Architecture Lighting



BEIP3M SA 70 MH DE 218/226 RF  
BEIP3M SA 150 MH DE 218/226 RF

## Designer Poles

### Applications

Parks and gardens, Pathways, Landscape lighting, Residential colonies, etc.

### Specification

State-of-art black painted GI pole, with base plate, fixing holes are provided on base plate for direct mounting on concrete pedestal.

Light opening holes are provided on pole as a navigator.

"Omega" integral indirect luminaire with tilted dish installed on single arm.

Integral luminaires suitable for 70/150 MH DE, all accessories are wired upto the terminal block.

2x18/26W retrofit CFL carriage is inbuilt in pole for navigator application.

Fully vermin and weather proof

New generation accessories

Easy to install and maintain

Degree of protection : IP 54

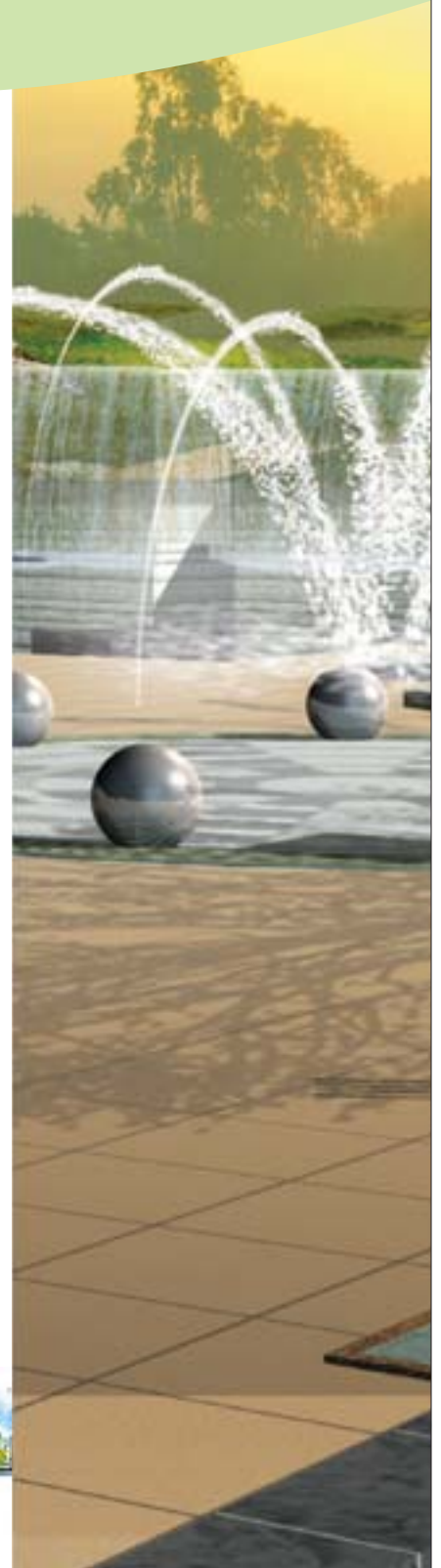
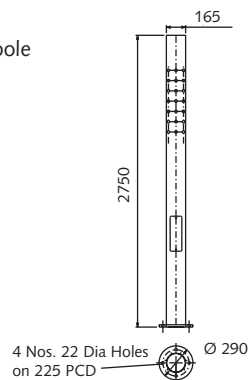





## Bajaj Electricals Limited

BRANCH	PHONE	FAX	E-mail
<b>AHMEDABAD</b> 106, Sakar III, Off Ashram Road Navrangpura, Ahmedabad 380 014.	079-27543964, 27543967, 27540397	079-27543950	lum_am_ahm@bajajelectricals.com
<b>BANGALORE</b> Bajaj Bhavan, No. 16, Residency Road, Bangalore 560 025.	080-22235486, 22238984, 22275505	080-22214878, 22275505	lum_am_ban@bajajelectricals.com
<b>BHUBANESWAR</b> Kharavela Nagar, Janpath, Bhubaneswar 751 001.	0674-2390697, 2396980, 2394052	0674-2390294	lum_am_bh@bajajelectricals.com
<b>CHANDIGARH</b> SCO 52, Sector-26, Madhya Marg, Chandigarh 160 026.	0172-4303211	0172-2792932	lum_am_chd@bajajelectricals.com
<b>CHENNAI</b> Navin's Presidium, 8th Floor, A- Block, Old No.103-A, Nelson Manickam Road, Aminjikarai, Chennai 600 029	044-42162200	044-42163300	lum_am_che@bajajelectricals.com
<b>COCHIN</b> CRL House, 42/1107, Tata Oil Mills Road, Cochin 682 018.	0484-2391119, 2396128, 2392039	0484-2391744	lum_am_ccn@bajajelectricals.com
<b>DELHI</b> 1/10, Asaf Ali Road, New Delhi 110 002	011-23236055, 23233056, 23235057	011-23230214	lum_am_del@bajajelectricals.com
<b>GUWAHATI</b> Agarwal House, Christian Basti, G. S. Road, Guwahati 787 005.	0361-2346497, 2346498, 2346499	0361-2346496	lum_am_guw@bajajelectricals.com
<b>HARYANA</b> 1/10, Asaf Ali Road, New Delhi 110 002	011-43725500	011-23230214	lum_am_hyr@bajajelectricals.com
<b>HYDERABAD</b> H. No. 6-3-1090/2, 3rd Floor, Vithal Das Chambers, Rajbhavan Road, Somaji Guda, Hyderabad 500 082.	040-23442932, 23442933, 2344293	040-23302745	lum_am_hyd@bajajelectricals.com
<b>INDORE</b> Commerce House, 3 rd Floor, 7 Race Course Road, Indore 452 003, MP.	0731-2548909/10/18	0731-2548911	lum_am_ind@bajajelectricals.com
<b>JAIPUR</b> Raghukamal Niwas, M. I. Road, Jaipur 302 001.	0141-2377364, 2369541, 2369542	0141-2374261	lum_am_jai@bajajelectricals.com
<b>KOLKATA</b> 10, Ganesh Chandra Avenue, Kolkata 700 013.	033-22379270, 22377657, 22216638	033-22259111	lum_am_cal@bajajelectricals.com
<b>LUCKNOW</b> Bajaj Bhavan, 21/32 A, Tilak Marg, Lucknow 226 001.	0522-2620595, 2613549	0522-2626513	lum_am_luc@bajajelectricals.com
<b>MUMBAI</b> Harchandrai House, 3rd Floor, 81, Queens Road, Marine Lines, Mumbai 400 002.	022-22089091	022-22089193	lum_am_mum@bajajelectricals.com
<b>NAGPUR</b> 2nd Floor, Saraf Court, Opp. Yashwant Stadium, Dhantoli, Nagpur.	0712-2440318, 2440319	0712-2420102	lum_am_war@bajajelectricals.com
<b>NOIDA</b> Flat No. 505-507, 5th Floor, Vikrant Tower, 4, Rajendra Place, Pusa Road, New Delhi 110 008.	011-25711961, 25861963, 25861964	011-25861962	lum_am_del2@bajajelectricals.com
<b>PATNA</b> Kashi Place, Dak Bunglow Road, Patna 800 001.	0612-2231427, 2220155, 2225911	0612-2231978, 2231427	lum_am_pat@bajajelectricals.com
<b>PUNE</b> Maneck Hall, 2, General Thimmayya Road, Pune 411 001.	020-26360801, 26361321, 26360703	020-26360698	lum_am_pun@bajajelectricals.com
<b>RAIPUR</b> Bajaj Bhavan, G. E. Road, Near Mahaveer Garden, Raipur 492 001.	0771-2263986, 2263976, 2660166	0771-2263310	lum_am_rai@bajajelectricals.com
<b>LUMINAIRES HEAD OFFICE and R&amp;D OFFICE</b>			
15/17, Sant Savta marg, Reay Road, Mumbai 400 010.	022-2376 5000	Fax: 022-2373 0504	
<b>HEAD OFFICE</b>			
51, Mahatma Gandhi Road, Mumbai 400 001.	022-22043780, 22851462, 22875135	Fax: 022-22828250	
<b>REGISTERED OFFICE</b>			
45/47, Veer Nariman Road, Mumbai 400 001.	022-22043841, 22045046, 22045341	Fax: 022-22851279	



**Bajaj Electricals Limited**

*Inspiring Trust*

**LUMINAIRES BUSINESS UNIT**

15/17, Sant Savta Marg, Reay Road, Mumbai - 400 010.  
Tel. : 2376 5000 Fax : 022-23730504  
E-mail : [luminaires@bajajelectricals.com](mailto:luminaires@bajajelectricals.com)  
Website : [bajajelectricals.com](http://bajajelectricals.com)