

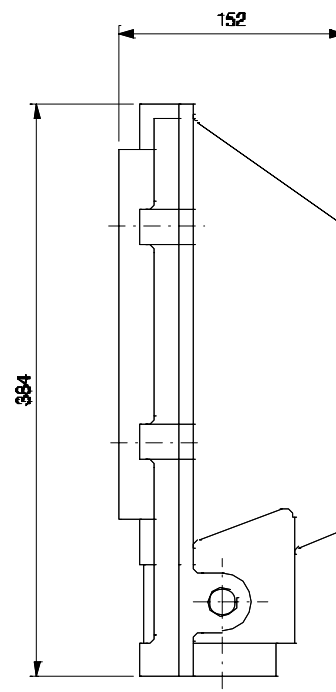

**FLAMEPROOF BULKHEAD LUMINAIRE  
FOR HAZARDOUS AREAS**

**BJFB 150/200**

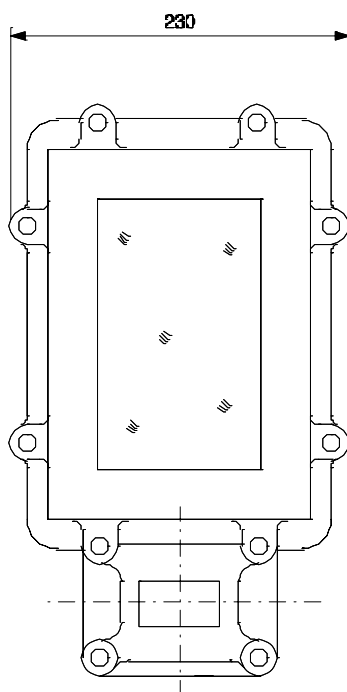

Nominal dimensions in mm Tolerance +/-5

**Specification**

**DESCRIPTION:** Flameproof Bulkhead suitable for 80/125W HPMV / 70/150 HPSV/MH Lamp, 100/150/200W GLS /160W MLL / 1x26W CFL lamps at 250 V AC max.

**MATERIAL:** Cast Iron / Cast aluminium LM6

**GLASS:** Heat resistant and toughened.

**CABLE ENTRY:** 2 way 3/4" B.S.Conduit.

**HOLDER:** BC/ES holder is provided as standards.

**FINISH:** Light grey (631 Shade IS5) paint. / Epoxy optional at extra cost.

**STANDARD:** IS: 2148 & 2206 (part I)

**GROUPS:** I, II A & II B as per IS 2148 / **ZONE** - 2

**CMRI. CERT. No. :** C.M.R.I./T.C./P/H 401 dated. 21 Oct. 1997.

CIMFR/TC/SR/H909 dated 8<sup>th</sup> February 2008.

CIMFR/TC/S/695 dated 19<sup>th</sup> November 2008.

**TEMP. CLASS :** 200W GLS - X; 125W MV – Y; 160W MLL – X

**TEMP. RANGE :** 150/200 GLS,160 MLL,125 MV,150 SV/MH – T3  
80 MV,70 SV/MH,100 GLS – T4 & 26W CFL – T6

Data subject to variation due to change/improvement in the design, materials and processes.

<p><b>BAJAJ LUMINAIRES</b> Making the difference</p>	DRAWN	VDS	25-06-2005	FOR – Std.
	CHECKED	CRR		REV - 0 DATE-25-06-2005
	APPROVED	CRR		DRG.No
	DATA SHEET RELEASED ON DT-			<b>FB 150/200 - 001</b>
<b>BAJAJ ELECTRICALS LIMITED</b> 15/17, SANT SAVTA MARG, REAY ROAD, MUMBAI-400 010.				* E-mail : <a href="mailto:luminaires@bajajelectricals.com">luminaires@bajajelectricals.com</a>