

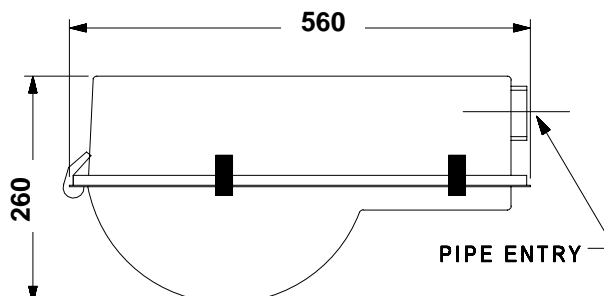

ROADWAY LIGHTING LUMINAIRE

BJMSD 04 250 SV



Max. Width –360 mm

NOMINAL DIMENSIONS IN mm Tolerance +/-5

Applications

- Main roads
- Traffic roundabouts
- Junctions
- Civic centers, etc.

Specification

- Hydro formed sheet aluminium housing in Stove enamelled grey hammertone outside and white Inside.
- Electrochemically brightened and **anodised** aluminium side reflectors
- Clear acrylic bowl with anti-moth treated felt gasket fixed to the housing by SS toggles
- Control gear suitable for 250W HPSV lamp, GES lamp holder prewired upto the terminal block, to be wired with new 250W open construction ballast
- Side entry mounting suitable for 40 to 50 mm OD pipe bracket
- Degree of protection : IP 54

Electrical Data

Cat. Ref.	Lamp Type & Wattage (W)	Nominal Voltage (V)	Mains Current in Amps. at 240 V	Capacitor Mfd.	Power Factor
BJMSD 04 250 SV	HPSV 250	220/240	1.30	30	≥ 0.85

Data subject to variation due to change/improvement in the design, materials and processes.

	DRAWN	VDS	01-02-2007	FOR – STD.
	CHECKED	KS		REV - 0 DATE-01-02-2007
	APPROVED	CRR		DRG.No
	DATA SHEET RELEASED ON DT- FEB.2007			MSD 04 250 SV - 001
BAJAJ ELECTRICALS LIMITED 15/17, SANT SAVTA MARG, REAY ROAD, MUMBAI-400 010. * E-mail : luminaires@bajajelectricals.com				